



City of Pomona Planning Division  
**Patio Plan Check Requirements**

The following information is *required* by the Planning Division for Patio Plan Checks. For further information regarding submittal requirements please see the Planning Division during counter hours, Monday through Thursday 8:00 AM to 5:00 PM or by phone (909) 620-2191.

**Project Information**

- Property Owner
- Property Address
- Assessor's Parcel Number
- Zoning
- Lot Size
- Lot Coverage
- Scope of Work

**What is lot coverage?** Lot coverage is the total footprint area of all roofed structures on a given lot. Lot coverage requirements may vary by zone. To verify your zone's lot coverage requirements please see the Planning Division.

Please note that trellises, as depicted in the *Sample Images* are not considered roofed structures and should not be included in lot coverage.

**Lot Coverage Example**

Lot Size: 7,200 SF

(E) Garage	420 SF
(E) Single-Family Dwelling	1120 SF
(E) Porch	68 SF
(P) Patio	200 SF
<hr/>	
	1,808 SF

$$1,808 / 7,200 = .2511$$

Lot Coverage : 25%

**Sample Images** Provide images of the proposed patio material, if the proposed material is intended to mimic another material. An example of this would be an aluminum patio painted to resemble wood.



**Elevations and Materials**

Provide scaled elevation plans and indicate all proposed colors, materials, and architectural styles.

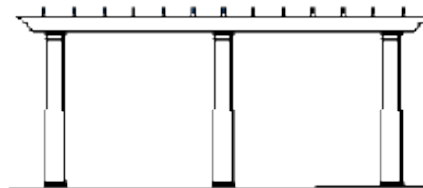
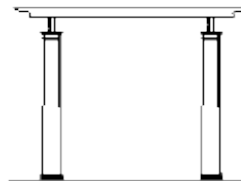

**Site Plan** Provide a site plan and calculations demonstrating the proposed lot coverage. Indicate the on the site plan the location of the posts.

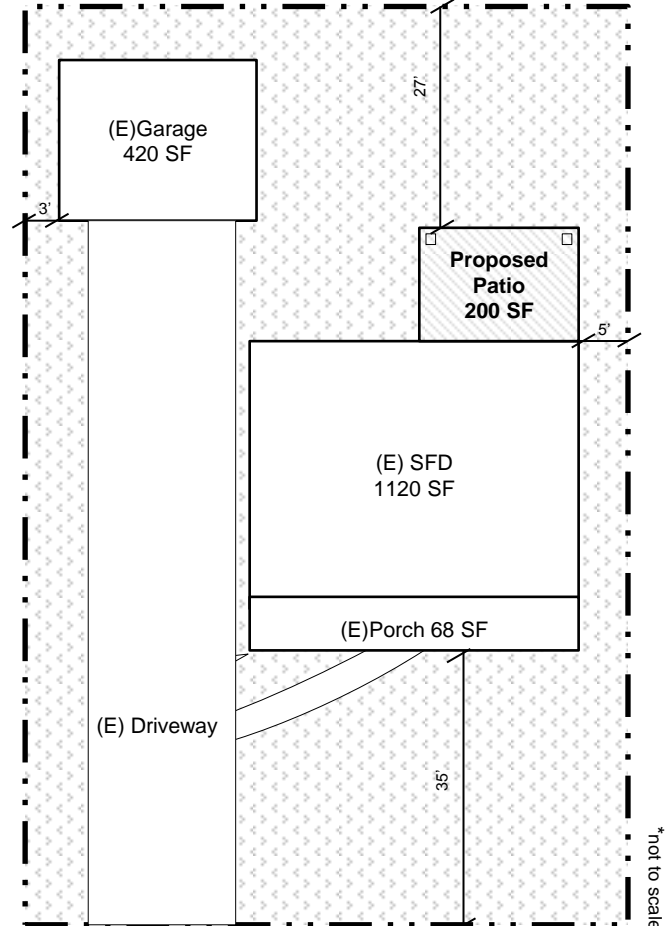

\*not to scale